

# S120 M...GM2 WHEEL DRIVE UNIT

## GENERAL DIMENSIONS

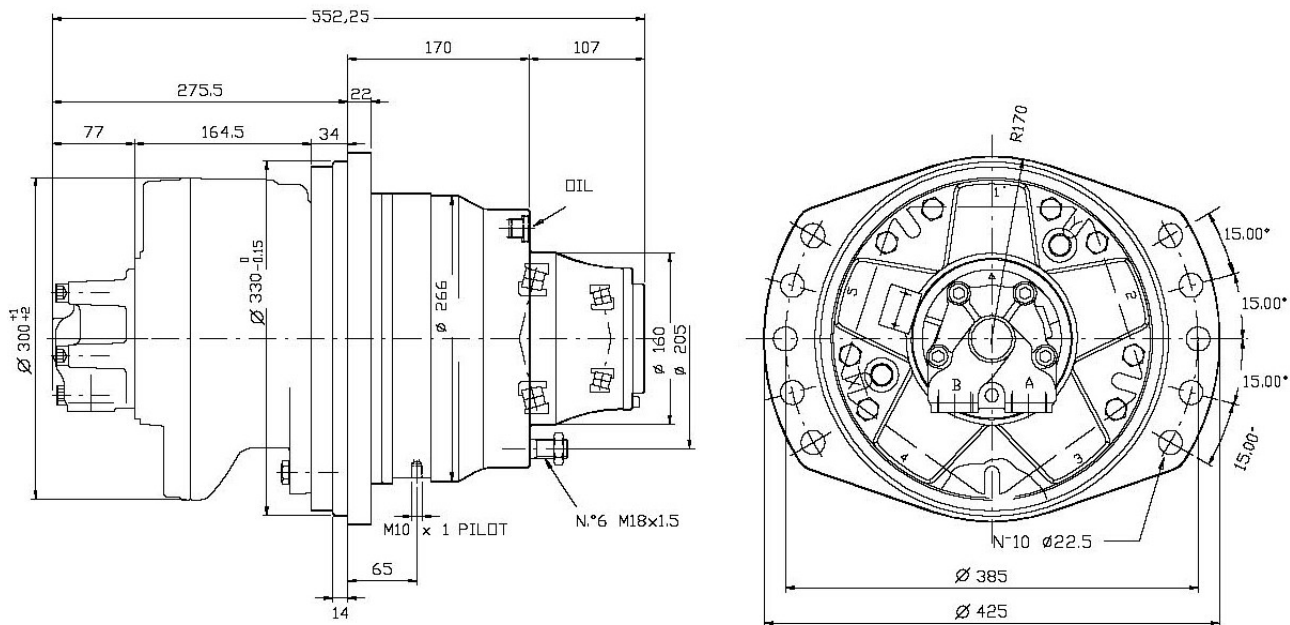

## MAIN TECHNICAL DETAILS

<b>Reduction ratio</b>	<b>4.8 : 1</b>
<b>Output Continuous torque</b>	<b>6.500 Nm</b>
<b>Output Peak torque</b>	<b>10.000 Nm</b>
<b>Static braking torque</b>	<b>7.000 Nm</b>
<b>Weight (gearbox+brake only)</b>	<b>75 kg</b>
<b>Gearbox case oil capacity</b>	<b>2 lit.</b>
<b>Max input speed</b>	<b>1.000 n / min.</b>
<b>Brake pilot pressure</b>	<b>12 bar (min) 60 bar (max)</b>