

S120 M WHEEL DRIVE UNIT

GENERAL DIMENSIONS

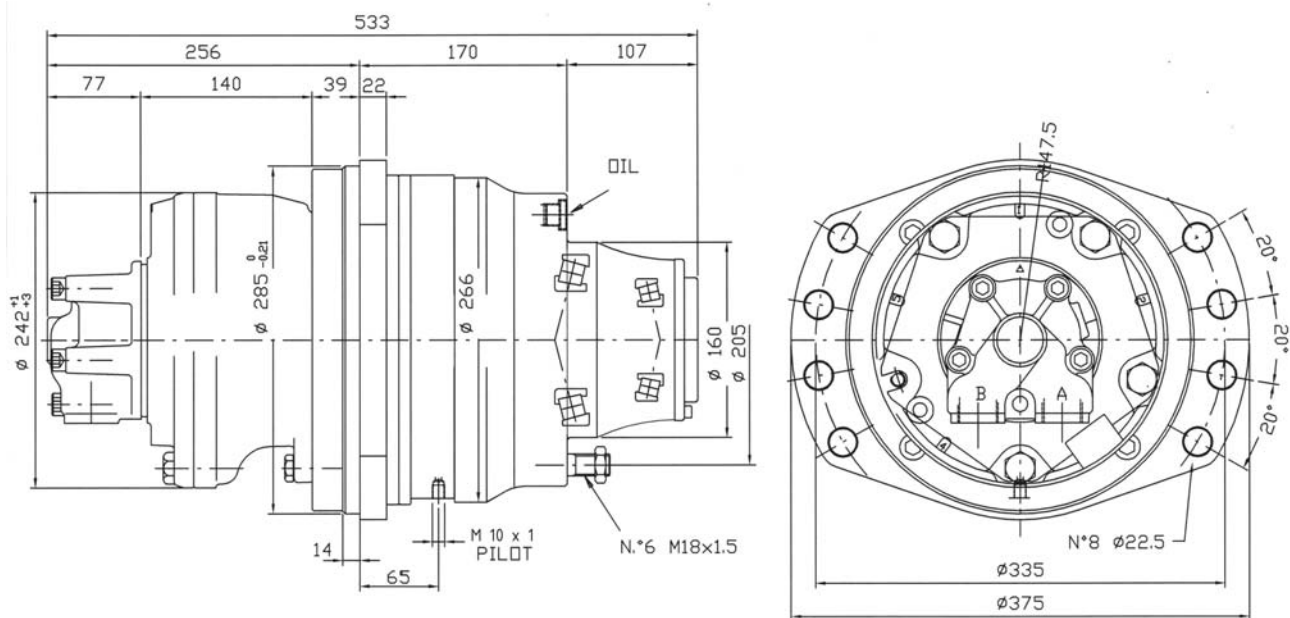

MAIN TECHNICAL DETAILS

Reduction ratio	4.8 : 1
Output Continuous torque	6.500 Nm
Output Peak torque	10.000 Nm
Static braking torque	7.000 Nm
Weight (gearbox+brake only)	75 kg
Gearbox case oil capacity	2 lit.
Max input speed	1.000 n / min.
Brake pilot pressure	12 bar (min) 60 bar (max)